

**COOLAIR X MOBILE AIR CONDITIONER  
USER MANUAL**



**PLEASE READ THIS USER MANUAL CAREFULLY AND RETAIN FOR FUTURE REFERENCE**



## **TECHNICAL SPECIFICATIONS**

Power supply	220-240v~, 50Hz
Cooling capacity	15000BTU/hr 4.3kw/hr
Power consumption for cooling mode	1650W 7.7A
Air volume	500 m <sup>3</sup> /hr
Moisture removal	40L/day
Compressor	Rotary
Refrigerant	R290 / 300g
Fan speed settings	3
Timer	24 hours
Working temperature	18 ~ 32°C
Exhaust pipe	Ø 165 x 1500mm
Net weight	40kg
Dimensions (W x D x H)	453 x 427 x 806mm

## **BEFORE USE**



- **READ THIS USER MANUAL CAREFULLY**
- **THIS APPLIANCE CONTAINS PROPANE GAS R290**
- **ENSURE THE ROOM TO BE COOLED IS AT LEAST 15M<sup>2</sup>**

## **SAFETY**

- **For indoor use only**
- Do not use in confined spaces
- Do not use in wet environments
- Leave the appliance to stand for at least 12 hours before connecting to the mains supply after transport or if the unit is tilted
- Keep upright on a flat, level surface
- Do not use in a potentially explosive environment containing combustible materials
- Ensure that there is at least 50cm space between the wall and the air appliance
- Do not place objects on the appliance or restrict the air inlet/outlet
- Children, pets and the mentally impaired should be supervised at all times while the appliance is in use
- Do not let children play with the appliance
- Switch off and unplug the appliance when not in use
- Do not leave the appliance unsupervised when in use
- Always disconnect from the mains by pulling the plug and never the cord
- Ensure the plug and power supply lead are always visible and easily accessible
- Do not use extension leads/reels with this appliance
- If the power supply lead becomes damaged, it must be replaced by a suitably qualified person
- Always ensure that the power supply is the same as stipulated on the data plate found on the appliance
- Keep filters clean
- Always inspect for damages prior to use and never use if damages are present
- Do not use the appliance for anything other than its intended purpose. This will be classified as misuse and will void warranty

## **SAFETY OF PROPANE REFRIGERANT R290**

- **Read all warnings carefully**
- This appliance contains refrigerant R290 and complies with all relevant European directives
- Do not perforate the refrigerant circuit
- Do not store near open flames
- Do not store or operate near heating appliances (gas or electric)
- Be aware, refrigerant R290 does not contain an odour
- Compliance with local gas regulations should be adhered to
- Keep ventilation openings clear of obstruction
- Store the appliance in a well-ventilated room when not in use
- Maintenance and repair should be carried out only by those who hold a qualification to handle fluorinated greenhouse gases

## **PARTS**

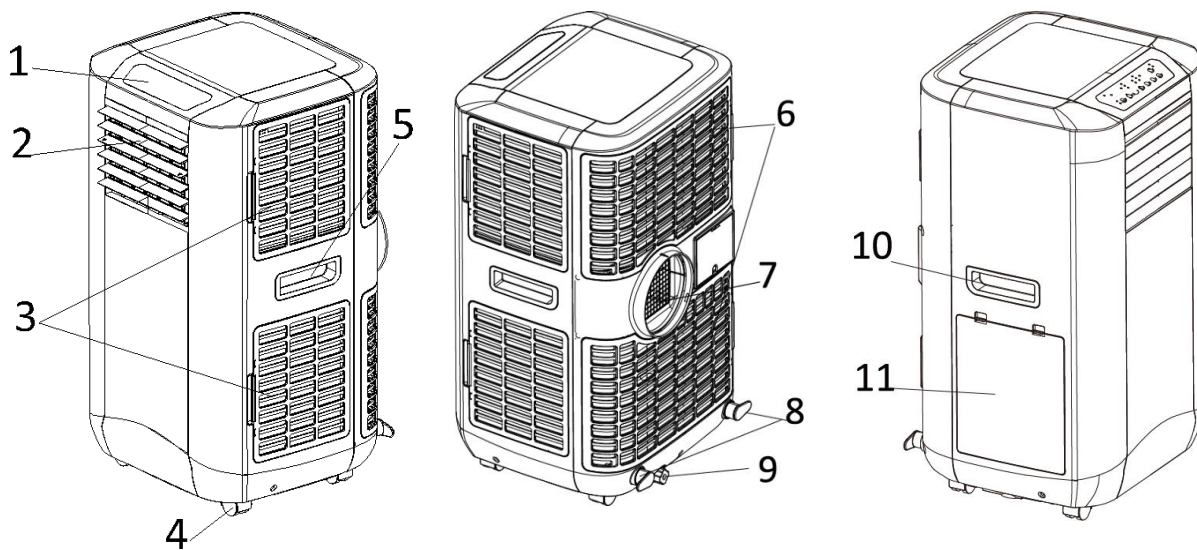

- |                                |                       |
|--------------------------------|-----------------------|
| 1. Control Panel               | 7. Exhaust Air Outlet |
| 2. Air Outlet                  | 8. Cord Storage       |
| 3. Side Air Filter (Air Inlet) | 9. Drainage           |
| 4. Caster                      | 10. Handle            |
| 5. Handle                      | 11. Water Bottle      |
| 6. Air Filter (Air Inlet)      |                       |

## **ACCESSORIES**

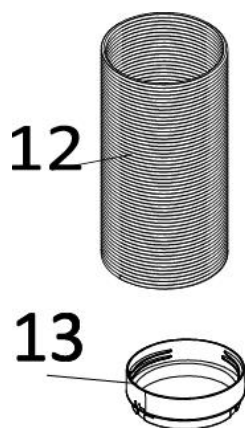

- |  |
|--|
| 12. Exhaust Hose   |
| 13. Round Adaptor – For Connecting The Exhaust Pipe To The Appliance |

## **INSTALLATION**

The unit is a portable air conditioner that may be moved from room to room.

### **General Information about Installation:**

Only open the window as far as necessary and guide the end of the hose to the outside.

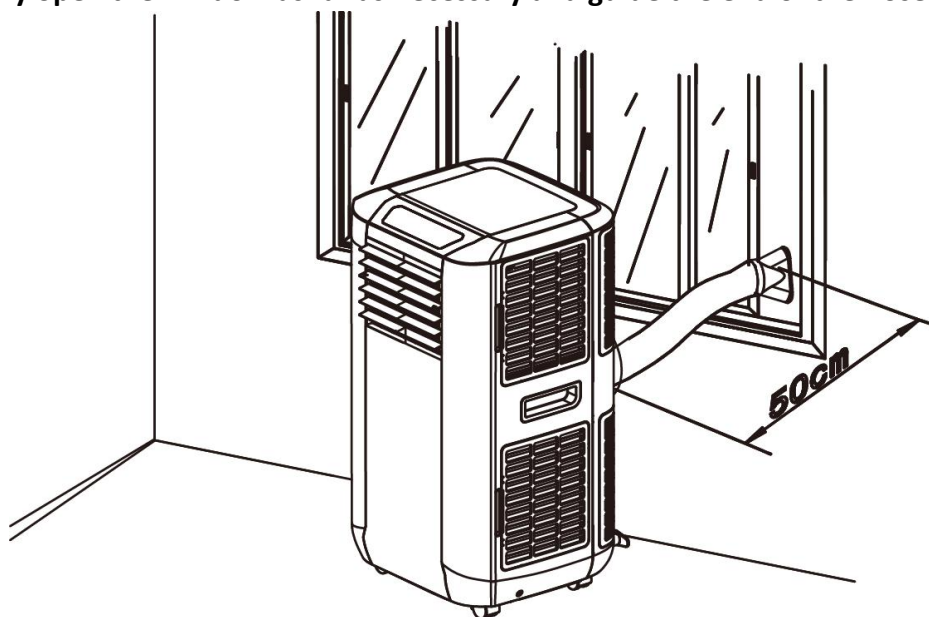

- Use only the hose provided. Clip the exhaust hose and unit adaptor to the back of the air conditioner

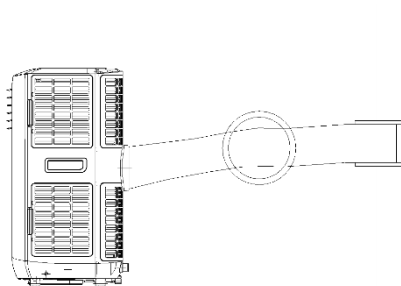

- Avoid kinks and bends in the exhaust hose as this will cause expelled moisture to build up causing the unit to overheat and shut down.

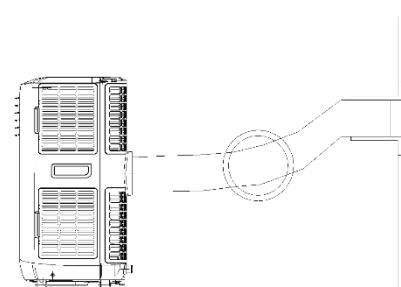

- The hose may be used from 300mm to 1500mm but for maximum efficiency use the shortest length possible.

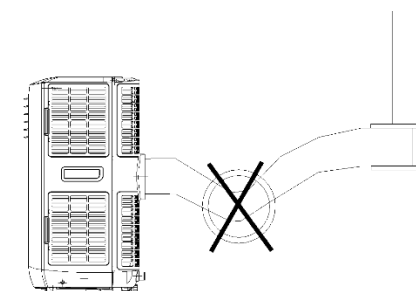

**WARNING:**

The exhaust pipe supplied with this appliance has been specifically designed for use with the appliance. Should it need replacing, please ensure that the correct length is used and that the part is a genuine Coolair X part.

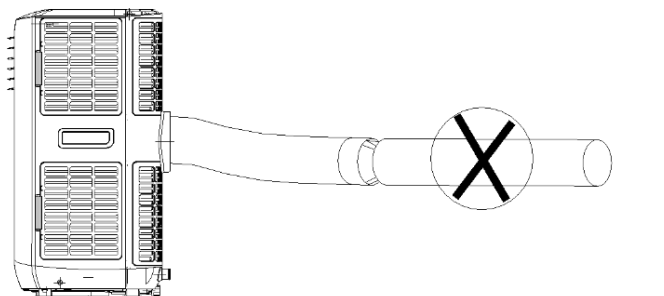

## **OPERATION**

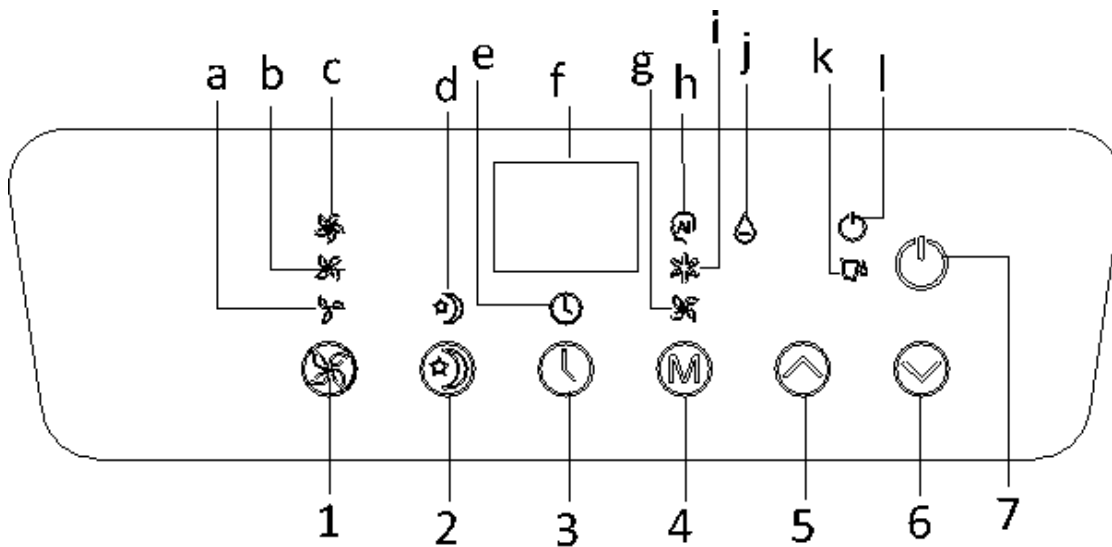

1. Fan speed
2. Sleep
3. Timer
4. Mode
5. Temperature UP
6. Temperature DOWN
7. Power

- A. Fan speed indicator (low)
- B. Fan speed indicator (medium)
- C. Fan speed indicator (high)
- D. Sleep mode indicator
- E. Timer indicator
- F. Display window
- G. Fan mode indicator
- H. Auto mode indicator
- I. Cool mode indicator
- J. Dehumidify mode indicator
- K. Water full indicator
- L. Compressor operation indicator

### **TURNING THE APPLIANCE ON/OFF**

Touch ON/OFF button, the unit will start in AUTO (automatic) mode.

### **AUTOMATIC MODE**

In automatic mode, the unit can cool, ventilate or dry depending on ambient temperature and set point adjustment. The unit is pre-set as follows:

1. If ambient temperature is  $> 24^{\circ}\text{C}$ , the unit will be in automatic cooling mode, the indicator for AUTO and COOL mode will light up. The compressor will switch on later when the temperature goes up to  $> 26^{\circ}\text{C}$ , indicator for COMPRESSOR light up. On the contrary, if the temperature goes down to  $< 26^{\circ}\text{C}$ , the indicator for COMPRESSOR will be off.
2. If the ambient temperature is  $< 24^{\circ}\text{C}$ , the unit will work in ventilation mode. During this operation, the indicator for AUTO and FAN mode light up:
3. The display window also shows the ambient room temperature from  $0^{\circ}\text{C}$  to  $50^{\circ}\text{C}$ .
4. The fan speed is not adjustable in AUTO mode.
5. To turn the unit off, press ON/OFF button again.

### **SETTING THE MODE**

Press the MODE button to select required working mode: cooling, fan or dehumidify.  
Confirm the correct indicator is displayed

### **SETTING THE TEMPERATURE**

1. Press the 'Temperature up' or 'Temperature down' button to select the temperature you desire.
2. The display window will show the temperature you set as the button(s) are pressed. Otherwise, it will always show the ambient temperature.

### **SETTING THE VENTILATION SPEED**

Press the SPEED button to choose the ventilation speed you need, high, medium or low. Confirm the correct indicator is displayed

### **SETTING THE TIMER**

1. Press the TIMER button to set the operating hours you desire (1 to 24 hours). When the set time has been reached, the machine will turn off automatically. The display window will show the hour(s) you set as you press TIMER button. If the timer button is not pressed, the unit will work continuously.
2. By pressing the timer button without turning on the other functions, you can PRE-SET the time for the machine to work. For example, if you press the timer to '2', the unit will work automatically after 2 hours.

### **Sleep function**

1. In cooling mode, by pressing the SLEEP button, the set temperature will increase 1°C at the 1st hour, another 1°C at the second hour, then keeps at that temperature.
2. In sleep mode, the ventilation will keep at low speed. Re-press the SLEEP button, the temperature setting and ventilation speed will return to the pre-selected one.
3. The unit will shut down automatically after the SLEEP function has been running for 12 hours.
4. Please note, the sleep function is not available while the machine is working in ventilation, dehumidification or auto mode. Only available in cooling mode.
5. When the machine is in Sleep function, the Fan Speed will turn to LOW speed.



## **DEHUMIDIFY MODE**

In dehumidify mode, the temperature cannot be adjusted, the ventilation will fix at low speed. When the unit is operating in Dehumidify mode, humidity extracted from the air is collected in an internal tank. If the tank reaches full, the compressor and motor cut out automatically. At the same time, the “Water Full” indicator comes on. An alarm will also sound. When the tank is full, drain the water as shown in the page concerning “DRAINAGE”. You may also use the unit without having to empty the tank so often by using “continuous drainage”, please also refer to the page about “DRAINAGE”.

### **Note:**

In dehumidify mode, when the temperature is  $< 15^{\circ}\text{C}$ , the compressor will stop, when the temperature goes up to  $> 17^{\circ}\text{C}$ , it will resume the work.

## **ADJUSTING THE AIR VENT**

Before using the appliance, please ensure you open the horizontal louver!

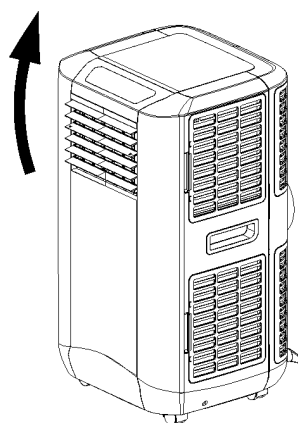

Adjust the vertical louvers to your desired direction

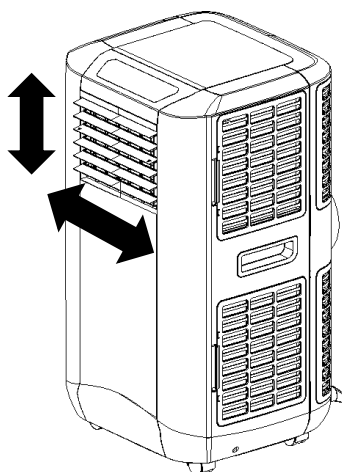

## SELF-DIAGNOSIS

This appliance is equipped with self-diagnosis function. If something is wrong in the machine, the display window will show the sign: E1, E2, E3 or E5, which reflects different condition. At this time, please call your service centre.

## EFFICIENCY BOOSTING

This appliance is equipped with “energy efficiency boosting” function, by adding water (3L max.) to the water gate at the side of the unit, the energy efficiency can be elevated. The principle is: while the machine is working, the condenser will be getting hot, if you add the water into the unit after the unit has been worked for more than one hour, the water will cool down the condenser, thus it consumes less power, i.e. saving energy.

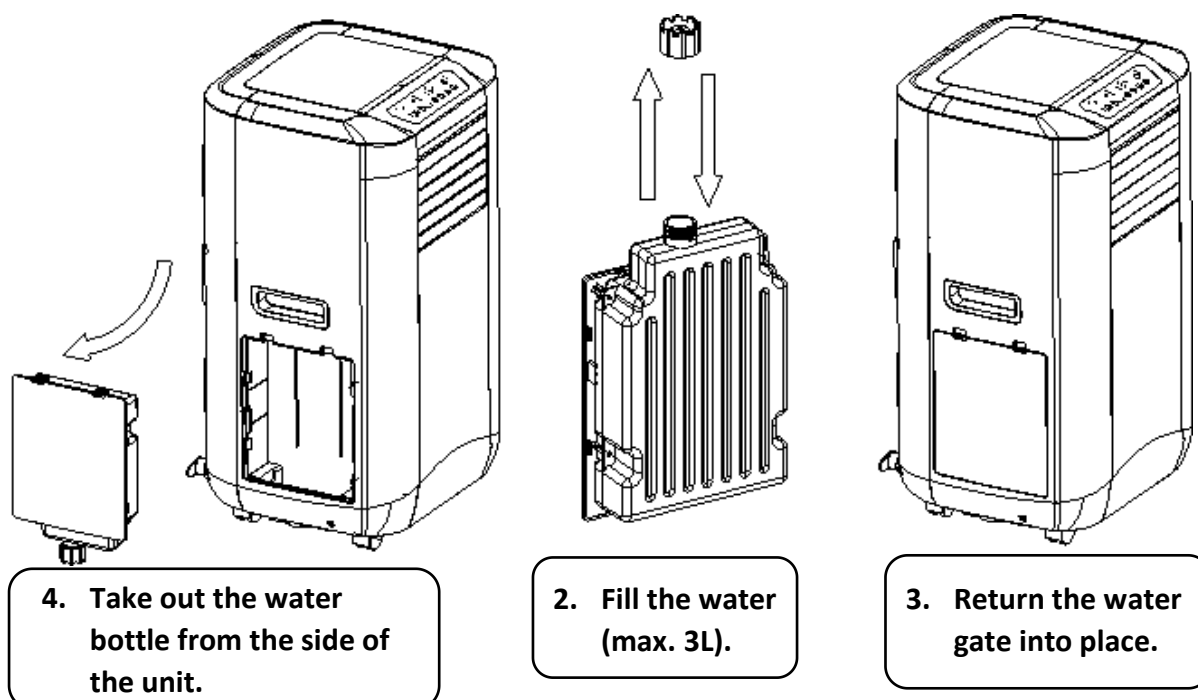

## NOTE

1. This efficiency feature by adding water is suggested to do after one hour operation and the water should NOT be over 3L, otherwise, the “water full” indicator will light in red and the unit will stop working.
2. In case the “water full” indicator is in red, please drain the water from the drain point at the back side of the unit until the red light goes out. The unit should work again now.

## IMPORTANT!

1. To prolong the compressor's life, after switching off of the unit, please wait for 3 minutes (at least) before turning back on.
2. The cooling system will switch off if the ambient temperature is lower than the set one. The ventilation, however, keeps working on the set level. If the ambient temperature rises above the selected level, the cooling will return to work.

## **DRAINAGE**

When the unit is operating in Cooling or Dehumidify mode, humidity extracted from the air is collected in an internal tank. If the tank reaches full, the compressor and motor cut out automatically. At the same time, the “Water Full” indicator comes on. An alarm will also sound. When the tank is full, carry out the following instructions:

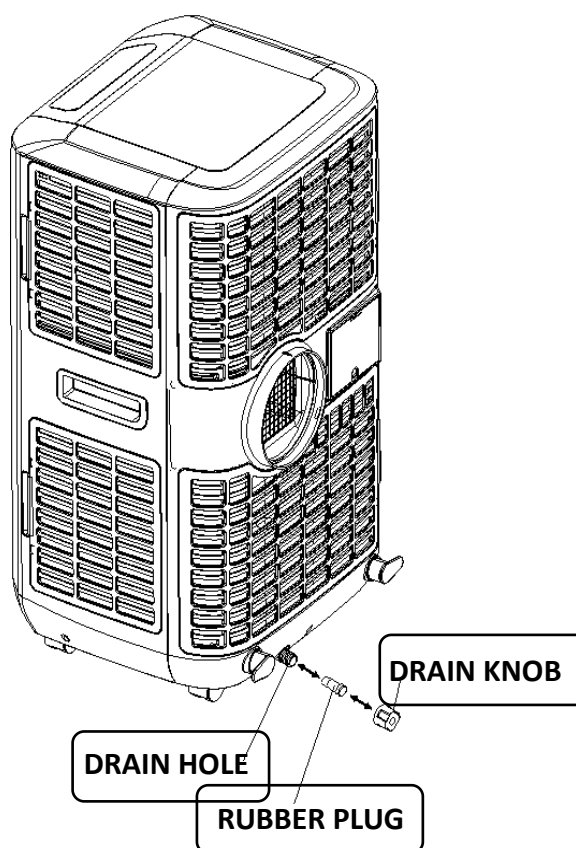

1. Turn off the air conditioner and avoid moving it when full.
2. Position a container (a water tray for example) underneath the drain hole.
3. Remove the drain knob & rubber plug from the drain hole and allow the water to drain out.
4. When the container is almost full, replace the rubber plug in the drain hole and empty the water tray.
5. Repeat until the unit is emptied.
6. Replace the rubber plug and tighten the drain knob firmly.
7. Switch on the unit - the full water or compressor operating indicator should not be flashing.

Should you prefer to use the appliance without having to empty the tank every so often, proceed as follows:

- Remove the drain knob and rubber plug and retain for future use.

- Connect the drain tube supplied to the water outlet as shown and locate the other end into a suitable water container or tray.

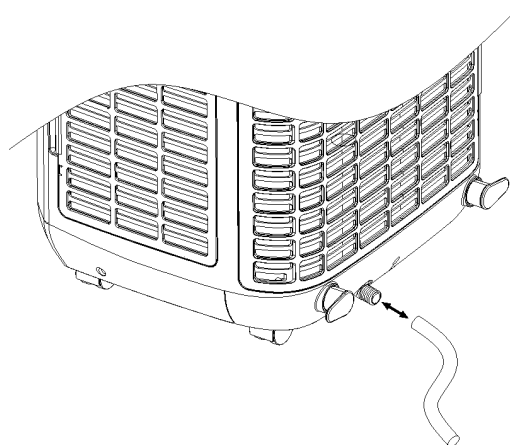

- The drain tube may be extended by adding an extension tube and using a suitable connector.

#### **PLEASE NOTE**

1. The drain must be at a lower level than the drain hole on the unit.
2. Flashing 'Water Full' indicator will not function in this mode of drainage.
3. If you want to extend the water tube, you can connect it with another tube (OD: 18mm).

## **MAINTENANCE**

Always unplug the air conditioner from the mains before cleaning. To maximize the efficiency of the air conditioner, clean the unit regularly.

### **CLEANING THE HOUSING**

Use a soft, damp cloth to wipe the body clean.

Never use aggressive chemicals, gasoline, detergents, chemically treated cloths, or other cleansing solutions. These all could possibly damage the appliance.

### **CLEANING THE FILTER**

Use a vacuum cleaner lightly over the filter to remove loose dust and dirt from the filters and then rinse thoroughly under running water (no hotter than 40°C).

Dry thoroughly before replacing.

Notice! Never operate the appliance without the filters.

## **END OF SEASON STORAGE**

- Drain any water in the unit before completely operating the unit on ventilation only mode for a few hours, to thoroughly dry the inside.
- Clean or change the filter
- Unplug and store the power cord on the cord hanger.
- Replace in the original carton or cover for storage.

## **TROUBLESHOOTING**

<b>The air conditioner does not run</b>	<ul style="list-style-type: none"><li>• Is the appliance plugged in?</li><li>• Is there a power failure?</li><li>• Is the 'full water' indicator flashing?</li><li>• Is the room temperature higher than the set temperature</li></ul>
<b>The appliance seems to do little</b>	<ul style="list-style-type: none"><li>• Is there direct sunshine?</li><li>• Are there too many doors/windows open?</li><li>• Is there a lot of people in the room?</li><li>• Is there something in the room producing a high amount of heat?</li></ul>
<b>The appliance seems to do nothing</b>	<ul style="list-style-type: none"><li>• Is the filter dusty or contaminated?</li><li>• Is the air intake or output blocked up?</li><li>• Is the room temperature higher than your selected temperature?</li></ul>
<b>The appliance is too noisy</b>	<ul style="list-style-type: none"><li>• Is the machine positioned unevenly so as to create vibration?</li><li>• Is the floor underneath the machine uneven?</li></ul>
<b>The compressor does not run</b>	<ul style="list-style-type: none"><li>• Is the overheat protection of the compressor on? Wait for the temperature to drop.</li></ul>

This marking indicates that this product should not be disposed of with other household waste throughout the EU. To prevent possible harm to the environment or human health from uncontrolled waste disposal, please recycle responsibly, to promote the sustainable reuse of material resources. To return your used device, please use the return and collection systems or contact the retailer from which the product was purchased. They can take this product for environmentally safe recycling

